

BRONZE PUMP SPA/MASSAGE



Item no. 11416

Technical data					Ampere	
Item no.	kW	Hz	Phase	Voltage	230V	400V
11416	0,37	50	3	230/400	1,75	1,0
11417	0,55	50	3	230/400	2,5	1,4
11418	0,75	50	3	230/400	2,95	1,7
11419	1,1	50	3	230/400	4,2	2,4
11424	0,37	50	1	230	2,5	-
11425	0,55	50	1	230	4,2	-
11426	0,75	50	1	230	5,0	-
11427	1,1	50	1	230	6,65	-

Technical data					
Item no.	kW	Hz	Phase	Voltage	Ampere
11416HZ	0,4	60	3	450	0,85
11417HZ	0,6	60	3	450	1,2
11418HZ	0,8	60	3	450	1,6
11419HZ	1,2	60	3	450	2,3

See chapter water treatment for suitable pump

- Pump housing and pump impeller made of bronze - For optimum quality and life.
- Pump shaft made of acid-resistant stainless steel - For increased corrosion protection.
- High-quality motors - For cost-effective operation and long life.
- Without pre-filter for massage jets - Highly efficient and compact.
- Tested and certified by a Notified Body - Important for product safety.

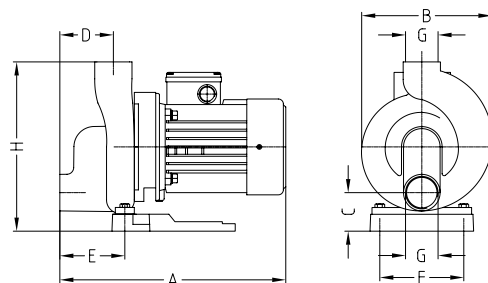
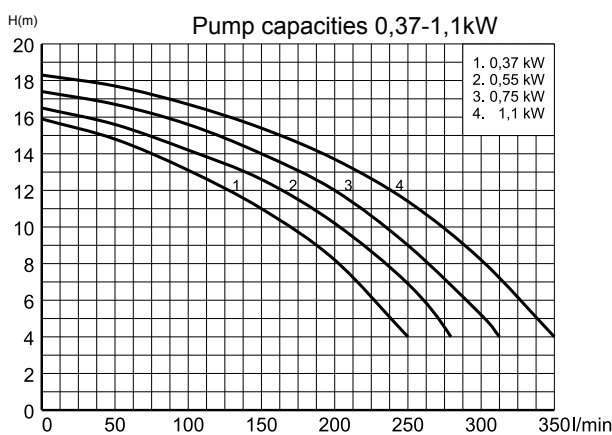

Dimensions

Item no.	A	B	C	D	E	F	G	H
11416, 11424, 11416HZ	365	190	56	78	100	125	1½"	250
11417, 11425, 11417HZ	365	190	56	78	100	125	1½"	250
11418, 11426, 11418HZ	400	190	56	78	100	125	1½"	250
11419, 11427, 11419HZ	400	190	56	78	100	125	1½"	250